

先进的设备制造

Advanced manufacturing equipment

优秀的品质，源于制造工艺的先进。丘里拥有先进的生产技术和设备，使产品内在品质与外在个性设计紧密结合，完美满足并引领工业现代化的需要。
Superior quality is originated from advanced manufacturing technology, with the use of advanced production and technical equipments, CHUELY products are given good quality and individualized design to fully meet and lead the requirements of industrial modernization.

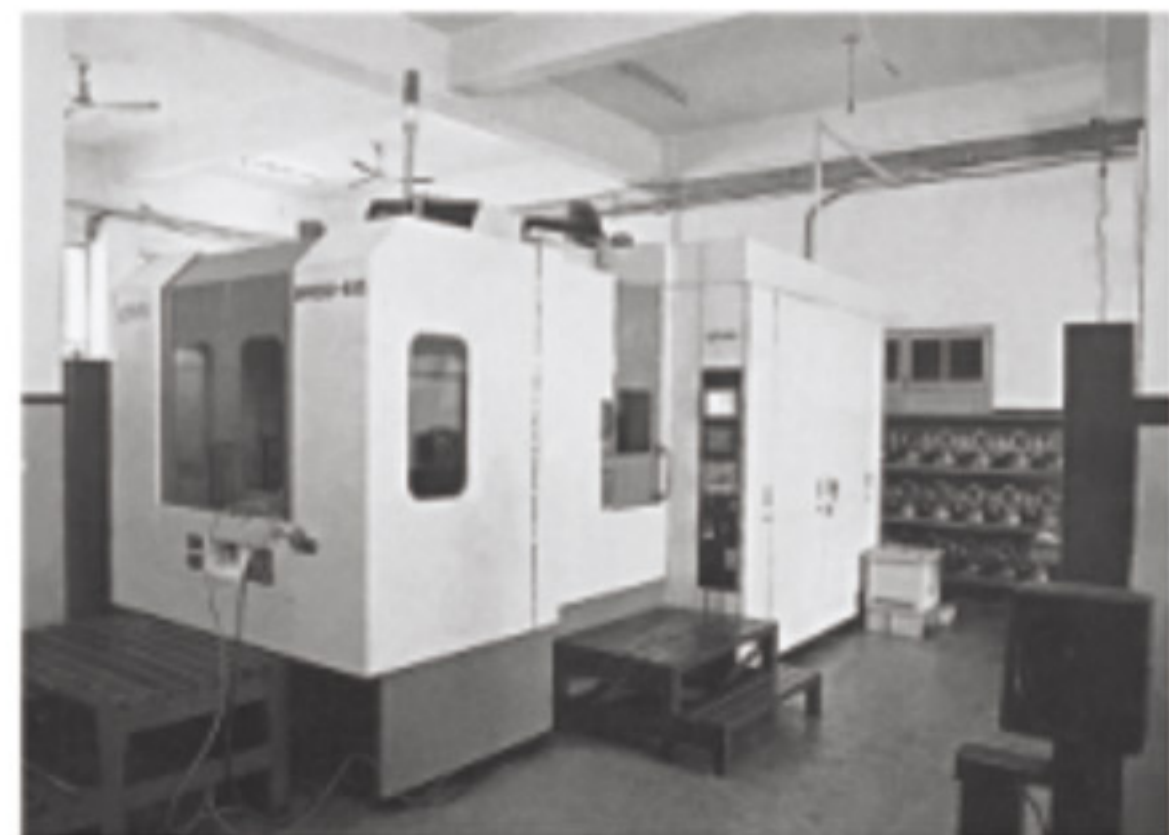
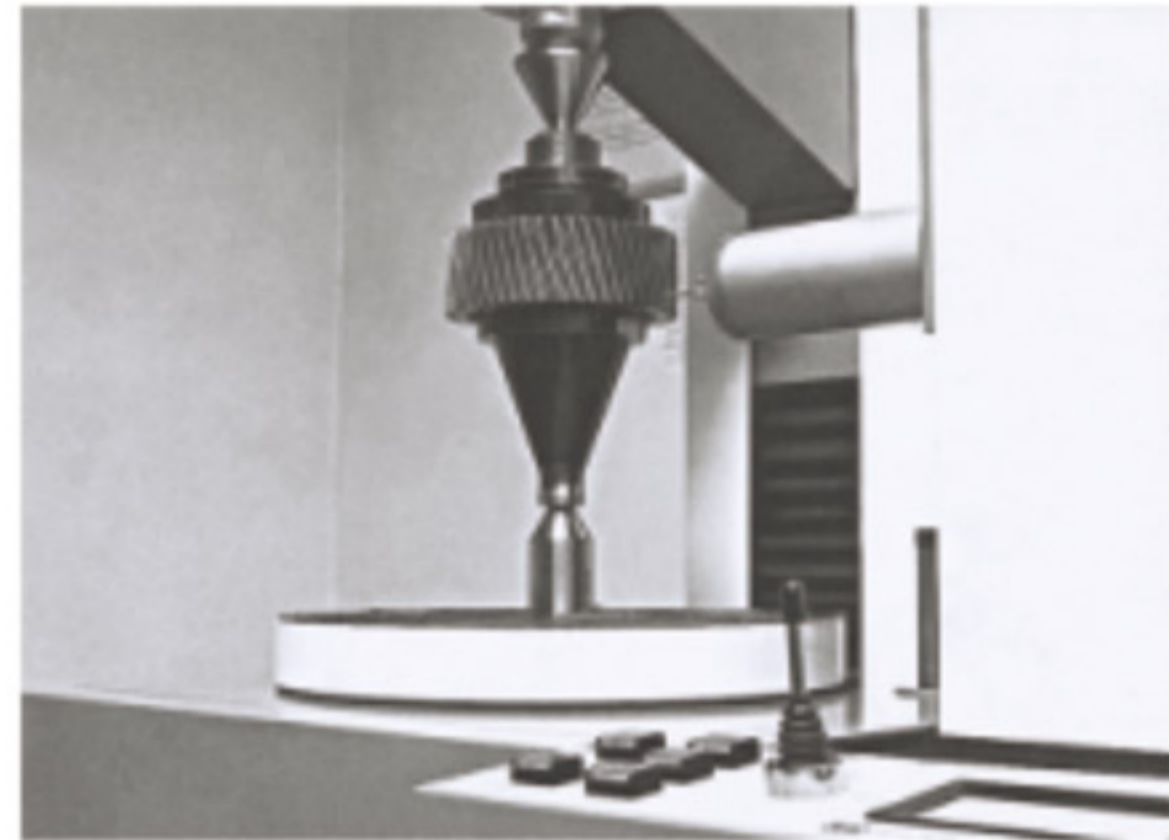
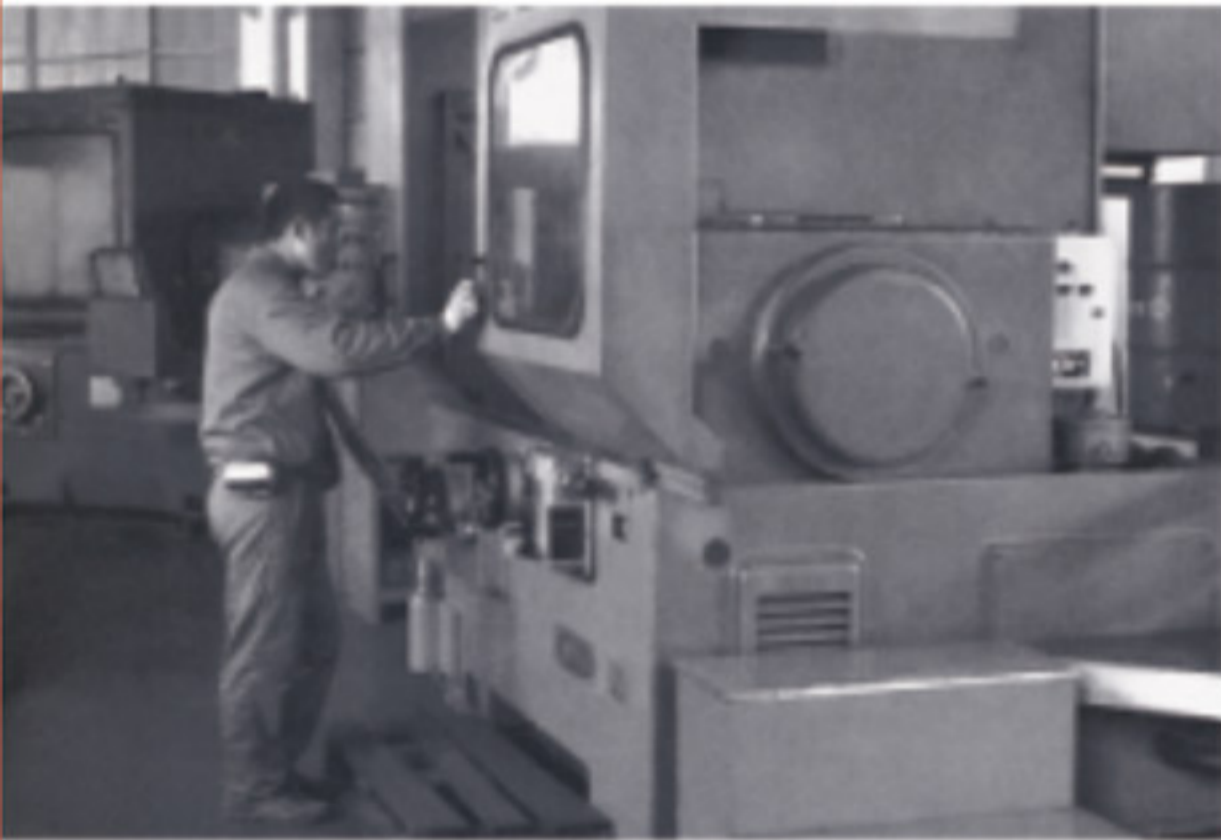

► G系列齿轮减速马达

G series gear reducer motor

► 产品特点

Characteristics

- 1、全封闭全寿命机电一体化设计/Closed case, long life, compact structure
- 2、硬齿面斜齿传动，低噪声、高效率/Helical hard-teeth, low noise, high efficiency
- 3、整体结构紧凑，重量轻，适应性强/Light weight, favorable adaptability
- 4、可附加电磁制动器/Can be added breaker

► 型号标记

Designation

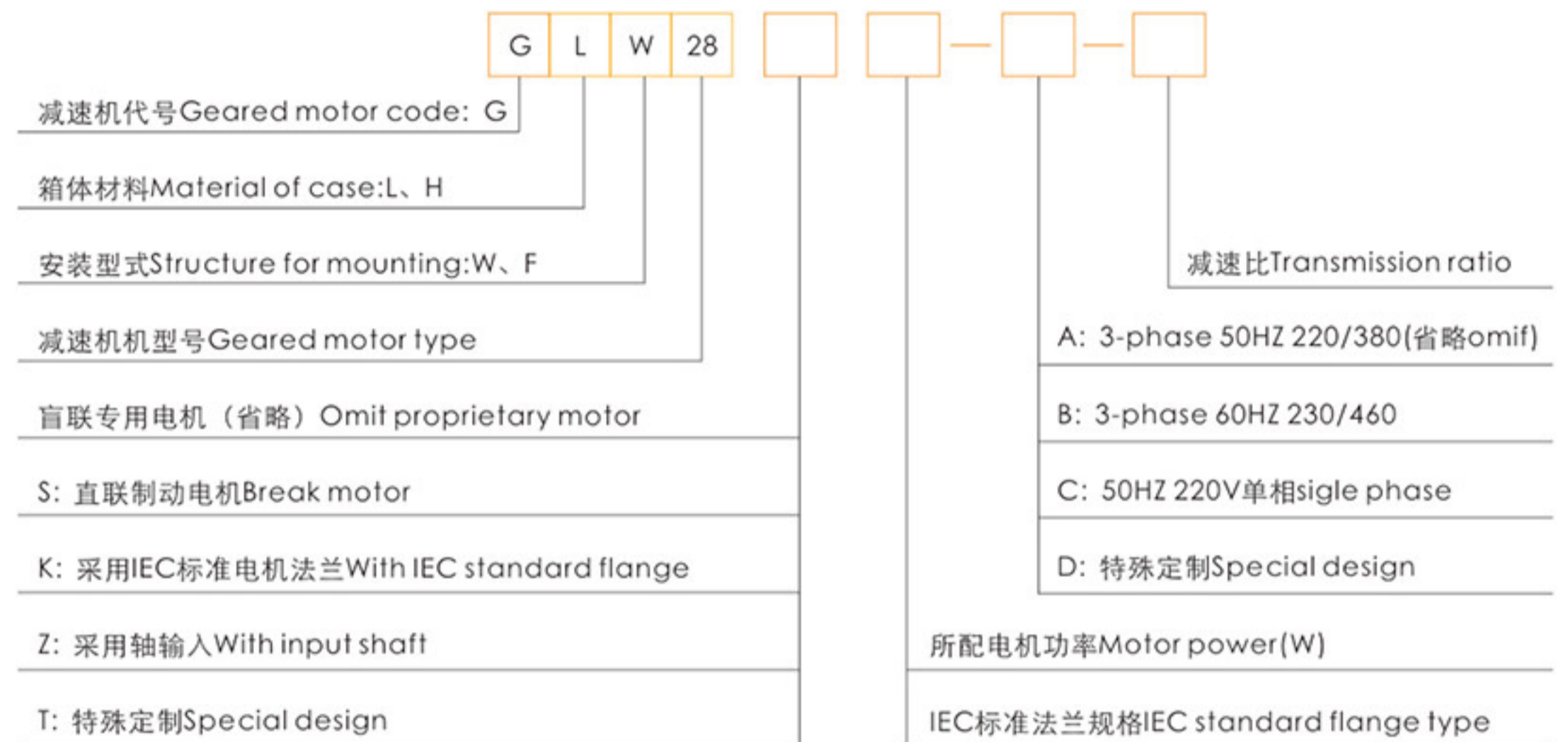

注：箱体材料：L—铝合金18、22、28 H—铸铁32、40、50 安装型式：w—底脚式、F—法兰式
Note: material of case: L—aluminium 18、22、28 H—cast iron 32、40、50 structure for mounting: W—foot-mounted、F—flange-mounted

► 标记示例

Example

- A GHWZ40-50
双轴铸铁箱体卧式，40机型号，减速比50。
Foot-mounted, cast iron case, type 40, ratio 50
- B GLF28-550-50
立式铝合金箱体，28号机型号，直联专用电机550W，减速比50。
Flange-mounted, aluminium case, type 28, ratio 50 motor power 550W
- C GLW28K-80B5-30
卧式铝合金箱体，28号机型号，输入端IEC标准电机法兰80B5，减速比30。
Foot-mounted, aluminium case, type 28, ratio 30 with IEC standard flange

▶ 马达及安全制动器特性表

Specifications of PL,PF Type Motor&brake

相 (Phase)	马力 (kw)	极数 (P)	电压 (V)	频率 (HZ)	定格Rating			绝缘 Class	转矩 (Kg·m)	释放时间Release Time			调整间隙Adjust Gap		附安全制动器 With Brake		
					转速 (R.P.M)	电流 (A)	转矩 (Kg·m)			交流一切体 AC Switch	直流别切 DC Switch	规定值 Specified Vaule	限属值 Boundary Vaule	刹车电压 Brake Volt	整流电压 Input Volt	使用次 数 Operation Times	
三 相 3 Φ	0.1	4P	220/380	60/50	1680/1380	0.8/0.46	0.058/0.071	E/F	0.1	0.1	0.06	0.3	0.7	DC90V	AC200 ~240V	10times /min	
	0.2		220/380	60/50	1680/1380	1.2/0.7	0.116/0.142	E/F	0.2	0.07	0.03	0.3	0.7				
	0.4		220/380	60/50	1680/1400	2.1/1.2	0.232/0.278	E/F	0.4	0.10	0.03	0.3	0.7				
	0.75		220/380	60/50	1680/1400	3.6/2.1	0.43/0.52	E/F	0.8	0.12	0.05	0.4	1.0				
	1.5		220/380	60/50	1680/1420	6.1/3.5	0.87/1.03	E/F	1.6	0.14	0.05	0.4	1.0				
	2.2		220/380	60/50	1680/1420	9.5/5.5	1.27/1.51	E/F	2.5	0.15	0.03	0.4	1.0				
3.7	220/380	60/50	1680/1420	15/8.7	2.14/2.54	E/F	5.0	0.17	0.05	0.5	1.2						
单 相 1 Φ	0.1	4P	110/220	60/50	1680/1380	2/1	0.058/0.071	E	0.1	0.1	0.06	0.3	0.7	DC90V	AC~100 ~110V AC~200 ~240V	10times /min	
	0.2		110/220	60/50	1680/1380	4/2	0.116/0.142	E	0.2	0.07	0.03	0.3	0.7				
	0.4		110/220	60/50	1680/1400	8/4	0.232/0.278	E	0.4	0.10	0.03	0.3	0.7				
	0.75		110/220	60/50	1680/1400	12/6	0.43/0.52	E	0.8	0.12	0.15	0.4	1.0				

▶ 减速机输出特性表

Specifications of gear reducer

(Kg/m×9.8)=N·M

减速比 Gear Ratio	出力转速 Out. rpm		0.1KW			0.2KW			0.4KW			0.75KW			1.5KW			2.2KW					
	50HZ	60HZ	出力轴容许扭力荷重			出力轴容许扭力荷重			出力轴容许扭力荷重			出力轴容许扭力荷重			出力轴容许扭力荷重			出力轴容许扭力荷重					
	型号 Type	型号 Type	50HZ Kg·m	60HZ Kg·m	O.H.L Kgf	型号 Type	50HZ Kg·m	60HZ Kg·m	O.H.L Kgf	型号 Type	50HZ Kg·m	60HZ Kg·m	O.H.L Kgf	型号 Type	50HZ Kg·m	60HZ Kg·m	O.H.L Kgf	型号 Type	50HZ Kg·m	60HZ Kg·m	O.H.L Kgf		
5	300	360	0.31	0.26	60	0.62	0.51	60	22	1.2	1	90	2.3	1.9	130	4.8	3.5	180	32	6.6	5.5	220	
10	150	180	0.62	0.51	90	1.2	1	90	22	2.5	2.1	120	4.6	3.9	180	8.8	7.1	250	32	13.2	10.7	320	
12.5	120	144	0.77	0.66	100	1.54	1.24	100	28	3.1	2.5	130	4.7	4.9	190	11	8.9	290	32	16.5	13.3	340	
15	100	120	0.93	0.77	100	1.85	1.5	100	28	3.7	2.9	140	6.9	5.8	220	13.2	10.7	290	32	19.8	16	360	
20	75	90	1.2	1	120	2.47	1.99	120	28	4.94	4	150	9.3	7.7	240	17.6	14.2	330	40	26.5	21.4	410	
25	60	72	1.5	1.3	130	3	2.47	130	28	6.17	4.9	170	11.6	9.6	250	22.1	17.8	390	40	33.1	26.7	480	
30	50	60	1.9	1.5	140	3.7	2.99	180	28	7.41	5.9	260	13.9	11.9	410	26.5	21.4	520	40	39.7	32.1	710	
40	37.5	45	2.4	2	150	4.94	3.99	190	28	9.88	7.98	290	17.9	14.9	430	35.3	28.5	600	40	53	42.8	740	
50	30	36	3	2.5	160	6.17	4.98	200	28	12.3	9.97	320	22.4	18.7	470	44.2	35.7	720	40	66.3	53.3	880	
60	25	30	3.6	3	220	7.4	5.98	220	32	14.8	11.9	350	26.9	22.4	560	53	42.8	720	40	79.5	64.2	1000	
75	20	24	4.6	3.7	220	9.2	7.5	220	32	18.5	14.9	350	35.1	28.3	560	66.3	53.5	720	40	99.4	80.3	1000	
90	16.6	20	5.5	4.5	250	11.1	9	250	32	22.2	17.9	350	42.1	34	600	79.5	64.2	720	50	119.3	96.3	1000	
100	15	18	6	5	250	12.3	9.9	250	32	24.7	19.9	350	46.8	37.8	600	88.4	71.4	720	50	132.6	107.1	1000	
120	12.5	15	7.2	6	250	14.8	11.9	340	32	29.6	23.9	600	58.4	47.3	720	106	85.6	1000	50	132.6	107.1	1000	
150	10	12	9.2	7.5	250	18.5	14.9	350	32	37	29.9	600	70.2	56.7	720	132.6	107.1	1000	50	132.6	107.1	1000	
180	8.3	10	11	9	250	22.2	17.9	350	32	44.4	35.9	600	84.2	68	720	132.6	107.1	1000	50	132.6	107.1	1000	
200	7.5	9	11.9	10	250	24.7	19.9	350	32	49.4	39.9	600	93.6	75.6	720	132.6	107.1	1000	50	132.6	107.1	1000	
300	5	6	17.5	14.9	350	35.1	28.3	600	40	70.2	56.7	720	132.6	107.1	1000								
1200	1.25	1.5	58.5	47.6	350	70.2	56.7	600	40	70.2	56.7	720	132.6	107.1	1000								
1800	0.83	1	58.5	47.6	350	70.2	56.7	600	40	70.2	56.7	720	132.6	107.1	1000								

▶ 减速机外壳材质表

Shell Material

型号Type	材质Material	型号Type	材质Material
18	ADC 12(铝合金Aluminum)	32	FC250(25)-(铸铁Cast Iron)
22	ADC 12(铝合金Aluminum)	40	FC250(25)-(铸铁Cast Iron)
28	ADC 12(铝合金Aluminum)	50	FC250(25)-(铸铁Cast Iron)

▶ 油量表

Oil Capacities

型号Type	注油量g	润滑Lubrication	替代油品	型号Type	注油量g	润滑Lubrication	替代油品
18	180	BT-860高温齿轮油	美孚Mobil SHC系列 Mobiltemp 0	32	650	BT-860高温齿轮油	美孚Mobil SHC系列 Mobiltemp 0
22	250			40	900		
28	500			50	1200		

▶ 齿轮减速马达结构图

Gear Reducer Structure

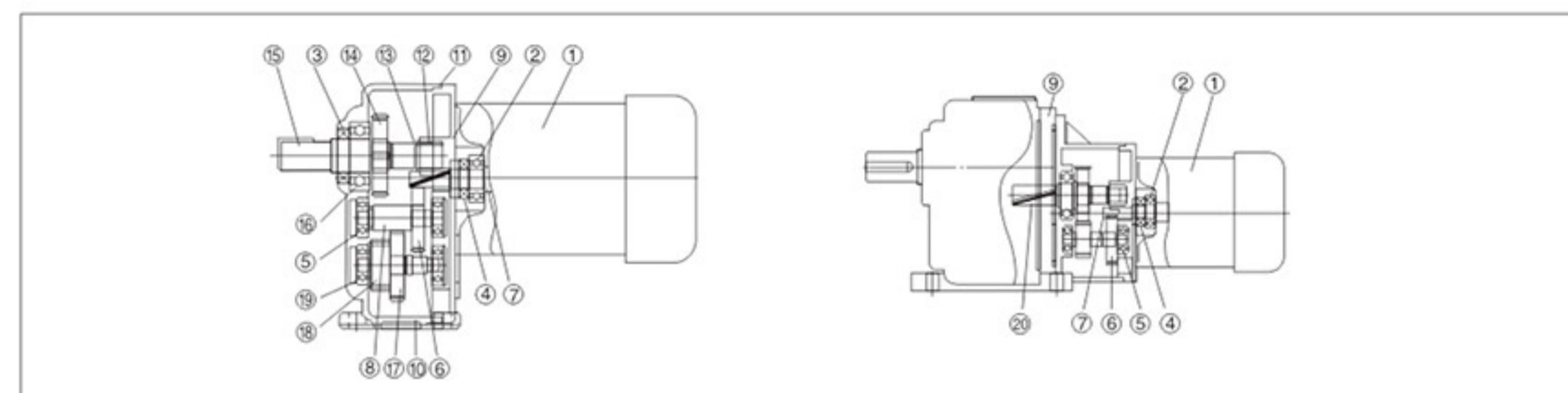

编号NO.	零件名称Name of Part	编号NO.	零件名称Name of Part	编号NO.	零件名称Name of Part
1	马达Motor	8	二段侧小齿轮轴2nd Stage Pinion Shaft	15	出力轴Output Shaft
2	马达轴承Motor Bearing	9	本体盖Body Cover	16	出力轴轴承Output Shaft Bearing
3	油轴封(出) Oil Seal(Out)	10	本体Body	17	二段侧轴承2nd Stage Gear
4	油轴封(入) Oil Seal(In)	11	油封胶圈"O" Ring	18	三段侧小齿轮轴3rd Stage Pinion
5	二段侧轴承2nd Stage Bearing	12	出力轴尖轴承Needle Bearing (sleeve)	19	三段侧轴承3rd Stage Bearing
6	一段侧齿轮1st Stage Bearing	13	推力垫圈Thrust Washer	20	中间段齿轮Middle Stage Gear
7	马达小齿轮轴Motor Pinion Shaft	14	出力齿轮Output Gear		

▶ 安全刹车结构图

Brake Structure

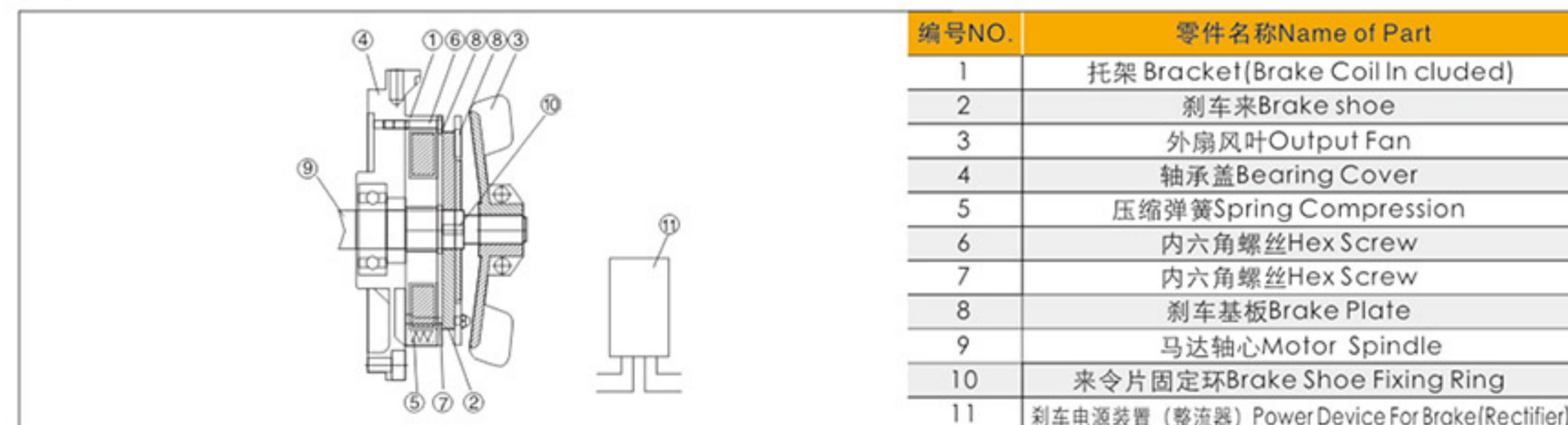

编号NO.	零件名称Name of Part
1	托架 Bracket (Brake Coil Included)
2	刹车来 Brake shoe
3	外扇风叶 Output Fan
4	轴承盖 Bearing Cover
5	压缩弹簧 Spring Compression
6	内六角螺丝 Hex Screw
7	内六角螺丝 Hex Screw
8	刹车基板 Brake Plate
9	马达轴心 Motor Spindle
10	来令片固定环 Brake Shoe Fixing Ring
11	刹车电源装置(整流器) Power Device For Brake (Rectifier)

G系列 (卧式) 三相齿轮减速马达
G series 3-Phase Horizontal Gear Reducer Motor (Foot Mounted)

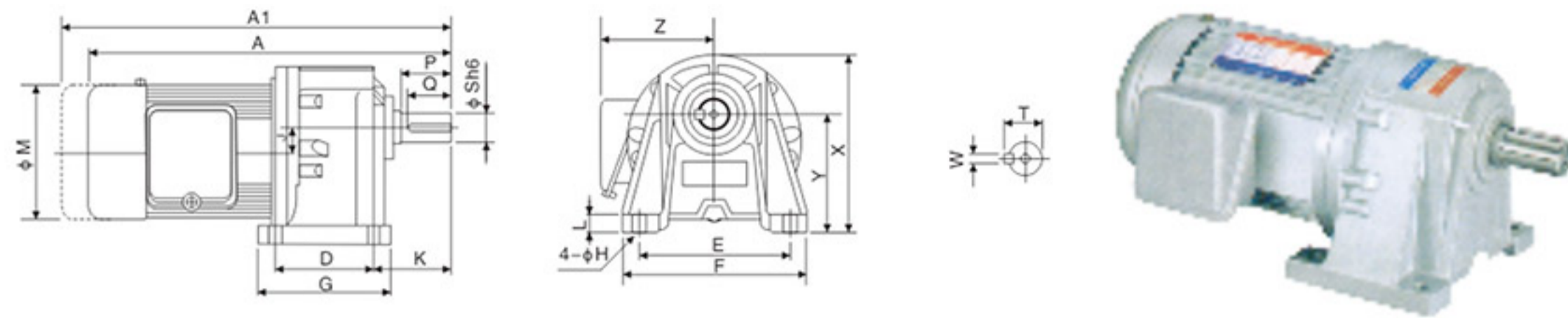

GH(L)W

马达尺寸表

Dimensions

Table with columns for Motor Power (KW), Gear Ratio, Type, Dimensions (A-Z), Output Shaft (P-W), and Weight (App. Wt. Kg). It lists specifications for various motor models from 0.1KW to 5HPx4P.

- 1. A1之长度为马达附刹车之总长/Length of A1 is the total length of motor and the brake.
2. *为轻扭力之机型/*Indicates motor of amaller torque.
3. 1/8~1 HP之刹车重量, 约无刹车重量加2KG/Weight of 1/8~1HP motor w/brake shall be weight of motor w/0 brake +2Kg.
4. 2~3 HP之刹车重量, 约无刹车重量加3.5KG/Weight of a 2~3HP motor w/brake is equal to motor w/0 brake +3.5Kg.
5. 40~50筒齿箱上附加O型吊环 (高度约50mm) /"O" type rings shall be attached to the 40~50mm gear box.(add.Height:50mm)
< 以上数值若有变动, 恕不另行通知>/We reserve the right to change without further notice.

G系列 (立式) 三相齿轮减速马达
G series 3-Phase Vertical Gear Reducer Motor (With Flange)

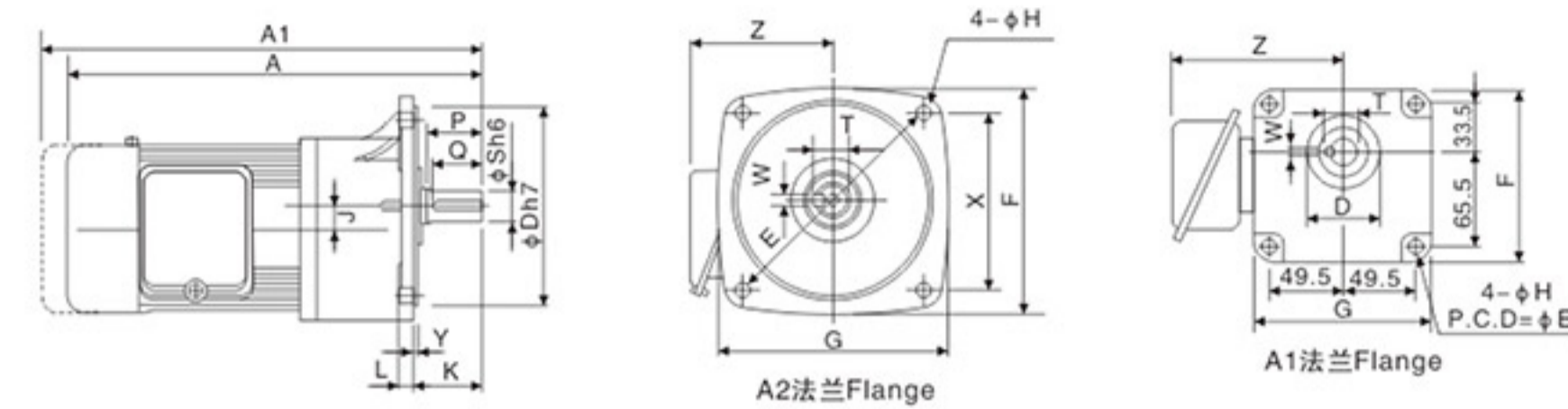

GH(L)F

马达尺寸表

Dimensions

Table with columns for Motor Power (KW), Gear Ratio, Type, Dimensions (A-Z), Output Shaft (P-W), and Weight (App. Wt. Kg). It lists specifications for various motor models from 0.1KW to 5HPx4P, including flange details.

- 1. A1之长度为马达附刹车之总长/Length of A1 is the total length of motor and the brake.
2. *为轻扭力之机型/*Indicates motor of amaller torque.
3. 1/8~1 HP之刹车重量, 约无刹车重量加2KG/Weight of 1/8~1HP motor w/brake shall be weight of motor w/0 brake +2Kg.
4. 2~3 HP之刹车重量, 约无刹车重量加3.5KG/Weight of a 2~3HP motor w/brake is equal to motor w/0 brake +3.5Kg.
5. 40~50筒齿箱上附加O型吊环 (高度约50mm) /"O" type rings shall be attached to the 40~50mm gear box.(add.Height:50mm)
< 以上数值若有变动, 恕不另行通知>/We reserve the right to change without further notice.

► G系列 (卧式) 单相齿轮减速马达

G series Single-Phase Horizontal Gear Reduction Motor(Foot Mounted)

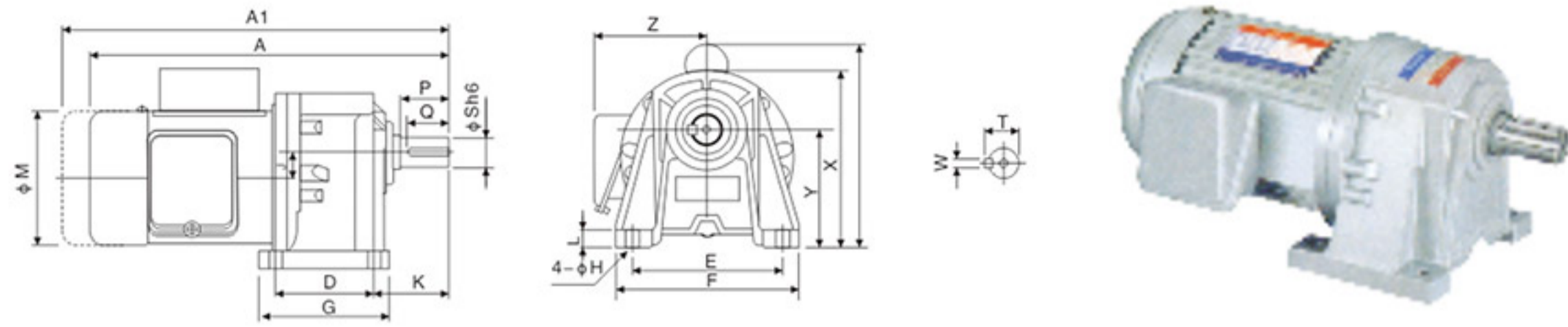

GH(L)W-C

► 马达尺寸表

Dimensions

马力 (KW)	减速比 Gear Ratio	框号 Type	A	A1	D	E	F	G	H	L	J	K	M	X1	X	Y	Z	出力轴端Output Shaft					重量 App.Wt.Kg
																		P	Q	S	T	W	
0.1KW 1/8HPx4P	3-50	18	255	282	40	110	135	65	9	10	16.5	50	133	-	133	88.5	116	30	270	18	20.2	5	5.6
	60~200	22	285	313	65	130	158	90	11	13	18	60	133	-	147	97.5	116	40	35	22	25	7	7.0
	250~1800	22*	356	383	65	130	158	90	11	13	18	60	133	-	147	97.5	116	40	35	22	25	7	8.9
	250~1800	28	380	407	90	140	178	120	11	16	22	70	133	-	171	116	116	45	40	28	31	7	11.6
0.2KW 1/4HPx4P	3~10	18	290	315	40	110	135	65	9	10	16.5	50	133	-	133	88.5	116	30	27	18	20.2	5	6.4
	12.5~25	18*	290	315	40	110	135	65	9	10	16.5	50	133	-	133	88.5	116	30	27	18	20.2	5	6.4
	12.5~100	22	322	347	65	130	158	90	11	13	18	60	133	-	147	97.5	116	40	35	22	25	7	7.9
	120~200	28	351	376	90	140	178	120	11	16	22	70	133	-	171	116	116	45	40	28	31	7	10.9
	250~1800	28*	428	453	90	140	178	120	11	16	22	70	133	-	171	116	116	45	40	28	31	7	12.4
	250~1800	32	462	487	130	170	210	165	13	18	27	75	133	-	208	140	116	55	50	32	36.5	10	24.6
0.4KW 1/2HPx4P	3~10	22	380	440	65	130	158	90	11	13	18	60	133	195	147	97.5	131	40	35	22	25	7	12.6
	12.5~25	22*	380	440	65	130	158	90	11	13	18	60	133	195	147	97.5	131	40	35	22	25	7	12.6
	12.5~100	28	410	470	90	140	178	120	11	16	22	70	133	210	171	116	131	45	40	28	31	7	15.0
	120~200	32	450	510	130	170	210	165	13	18	27	75	133	222	208	140	131	55	50	32	36.5	10	27.2
	250~1800	32*	530	590	130	170	210	165	13	18	27	75	133	-	208	140	131	55	50	32	36.5	10	29.6
	250~1800	40	600	660	150	210	265	200	18	24	32.5	89	133	-	252	162	131	65	60	40	44	10 (12)	47.2
0.75KW 1HPx4P	3~25	28	620	480	90	140	178	120	11	16	22	70	173	214	171	116	138	45	40	28	31	7	16.7
	30~120	32	450	510	130	170	210	165	13	18	27	75	173	227	208	140	138	55	50	32	36.5	10	29.8
	120~200	40	510	570	150	210	265	200	18	24	32.5	89	173	-	252	162	138	65	60	40	44	10 (12)	47.2
	250~1800	40*	610	670	150	210	265	200	18	24	32.5	89	173	-	252	162	138	65	60	40	44	10 (12)	49.7

- A1之长度为马达附刹车之总长/Length of A1 is the total length of motor and the brake.
 - *为轻扭力之机型/*Indicates motor of amaller torque.
 - 1/8~1 HP之刹车重量, 约无刹车重量加2KG/Weight of 1/8~1HP motor w/brake shall be weight of motor w/0 brake +2Kg.
 - 2~3 HP之刹车重量, 约无刹车重量加3.5KG/Weight of a 2~3HP motor w/brake is equalto motor w/0 brake +3.5Kg.
 - 40~50筒齿箱上附加O型吊环 (高度约50mm) /"O" type rings shall be attached to the 40~50mm gear box.(add.Height:50mm)
- < 以上数值若有变动, 恕不另行通知>/We reserve the right to change without further notice.

► G系列 (立式) 单相齿轮减速马达

G series Single-Phase Vertical Gear Reduction Motor(With Flange)

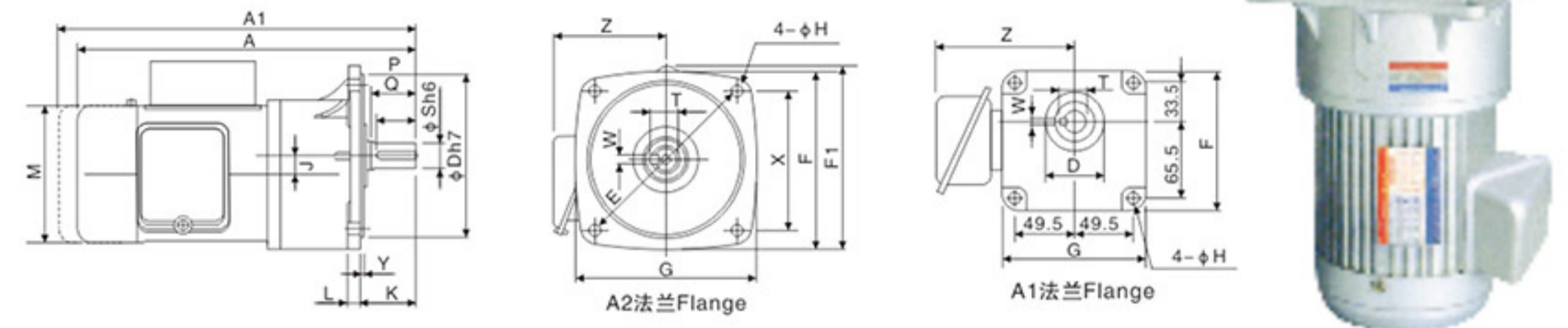

GH(L)F-C

► 马达尺寸表

Dimensions

马力 (KW)	减速比 Gear Ratio	框号 Type	A	A1	D	E	X	F	F1	G	H	L	J	K	M	Y	Z	出力轴端Output Shaft					重量 App.Wt.Kg	备注 Remark
																		P	Q	S	T	W		
0.1KW 1/8HPx4P	3-50	18	255	282	50	140	99	120	-	120	9	12	16.5	40	133	6	116	30	27	18	20.2	5	5.5	A1法兰
	60~200	22	285	314	148	185	131	175	-	165	11	12	18	48	133	3	116	40	35	22	25	7	7.3	A2法兰
	250~1800	22*	356	383	148	185	131	175	-	165	11	12	18	48	133	3	116	40	35	22	25	7	9.2	A2法兰
	250~1800	28	380	407	170	220	156	205	-	195	12	16	22	51	133	3	116	45	40	28	31	7	11.9	A2法兰
0.2KW 1/4HPx4P	3~10	18	290	315	50	140	99	120	-	120	9	12	16.5	40	133	6	116	30	27	18	20.2	5	6.5	A1法兰
	12.5~25	18*	290	315	50	140	99	120	-	120	9	12	16.5	40	133	6	116	30	27	18	20.2	5	6.5	A1法兰
	12.5~100	22	322	347	148	185	131	175	-	165	11	12	18	48	133	3	116	40	35	22	25	7	8.3	A2法兰
	120~200	28	340	365	170	220	156	205	-	195	12	16	22	51	133	3	116	45	40	28	31	7	11.7	A2法兰
	250~1800	28*	428	453	170	220	156	205	-	195	12	16	22	51	133	3	116	45	40	28	31	7	12.8	A2法兰
	250~1800	32	462	487	185	255	180	248	-	225	15	16	27	65	133	3	116	55	50	32	36.5	10	25.2	A2法兰
0.4KW 1/2HPx4P	3~10	22	380	440	148	185	131	178	195	165	11	12	18	48	133	3	131	40	35	22	25	7	11	A2法兰
	12.5~25	22*	380	440	148	185	131	178	195	165	11	12	18	48	133	3	131	40	35	22	25	7	11	A2法兰
	12.5~100	28	410	470	170	220	156	205	-	195	12	16	22	51	133	3	131	45	40	28	31	7	13.4	A2法兰
	120~200	32	450	510	185	255	180	248	-	225	15	16	27	65	133	3	131	55	50	32	36.5	10	24.4	A2法兰
	250~1800	32*	530	590	185	255	180	248	-	225	15	16	27	65	133	3	131	55	50	32	36.5	10	26.8	A2法兰
	250~1800	40	600	660	230	310	219	291	-	272	15	16	32.5	85	133	5	-	65	60	40	44	10 (12)	47.4	A2法兰
0.75KW 1HPx4P	3~25	28	420	480	170	220	156	205	209.5	195	12	16	22	51	173	3	138	45	40	28	31	7	15.1	A2法兰
	30~120	32	450	510	185	255	180	248	-	225	15	16	27	65	173	3	138	55	50	32	36.5	10	26.9	A2法兰
	120~200	40	510	570	230	310	219	291	-	272	15	16	32.5	85	173	3	138	65	60	40	44	10 (12)	47.4	A2法兰
	250~1800	40	610	670	230	310	219	291	-	272	15	16	32.5	85	173	5	138	65	60	40	44	10 (12)	49.7	A2法兰

- A1之长度为马达附刹车之总长/Length of A1 is the total length of motor and the brake.
 - *为轻扭力之机型/*Indicates motor of amaller torque.
 - 1/8~1 HP之刹车重量, 约无刹车重量加2KG/Weight of 1/8~1HP motor w/brake shall be weight of motor w/0 brake +2Kg.
 - 2~3 HP之刹车重量, 约无刹车重量加3.5KG/Weight of a 2~3HP motor w/brake is equalto motor w/0 brake +3.5Kg.
 - 40~50筒齿箱上附加O型吊环 (高度约50mm) /"O" type rings shall be attached to the 40~50mm gear box.(add.Height:50mm)
- < 以上数值若有变动, 恕不另行通知>/We reserve the right to change without further notice.

► G系列 (卧式) 双轴型齿轮减速机

G Series Horizontal Type Gear Reducer

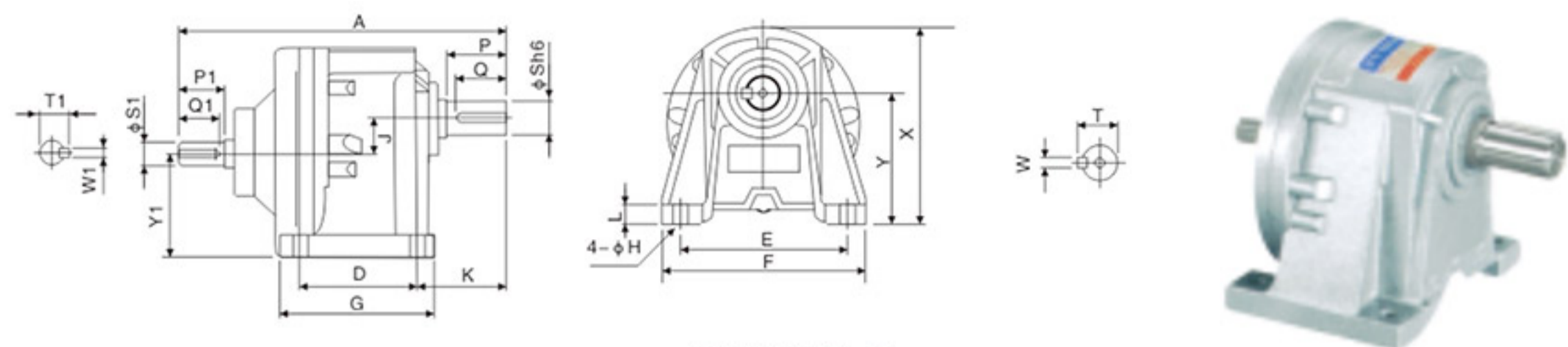

GH(L)W-Z

► 马达尺寸表

Dimensions

马力 (KW)	减速比 Gear Ratio	框号 Type	A	D	E	F	G	H	J	K	L	X	Y	Y1	出力轴端Output Shaft					入力轴端Input Shaft					重量 App.Wt.Kg	备注
															P	Q	S	T	W	P1	Q1	S1	T1	W1		
0.1KW	3-50	18	167	40	110	135	65	9	16.5	50	10	133	88.5	64	30	27	18	20	5	25	22	14	15.5	4	3	A1法兰
	60~200	22	194	65	130	158	90	11	18	60	13	147	97.5	79.5	40	35	22	25	7	25	22	14	15.5	4	4.2	A2法兰
0.2KW	5~10	18	167	40	110	135	65	9	16.5	50	10	133	88.5	64	30	27	18	20	5	25	22	14	15.5	4	3	A1法兰
	12.5~25	18*	167	40	110	135	65	9	16.5	50	10	133	88.5	64	30	27	18	20	5	25	22	14	15.5	4	3	A1法兰
	12.5~100	22	194	65	130	158	90	11	18	60	13	147	97.5	79.5	40	35	22	25	7	25	22	14	15.5	4	4.2	A2法兰
0.4KW	120~200	28	221	90	140	178	120	11	22	62	16	171	116	94	45	40	28	31	7	30	25	16	18	5	5.5	A2法兰
	5~10	22	194	65	130	158	90	11	18	60	13	147	97.5	79.5	40	35	22	25	7	25	22	14	15.5	4	4.2	A2法兰
	12.5~25	22*	194	65	130	158	90	11	18	60	13	147	97.5	79.5	40	35	22	25	7	25	22	14	15.5	4	4.2	A2法兰
	12.5~100	28	221	90	140	178	120	11	22	62	16	171	116	94	45	40	28	31	7	30	25	16	18	5	5.5	A2法兰
0.75KW	120~200	32	257	130	170	210	165	13	27	76.5	18	208	140	113	55	50	32	36.5	10	30	25	19	21	5	16	A2法兰
	5~10	28	221	90	140	178	120	11	22	62	16	171	116	94	45	40	28	31	7	30	25	16	18	5	6.5	A2法兰
	30~120	32	257	130	170	210	165	13	27	76.5	18	208	140	113	55	50	32	36.5	10	30	25	19	21	5	19.5	A2法兰
1.5KW	120~200	40	305	150	210	265	198	15	32.5	89	24	252	162	129.5	65	60	40	44	$\frac{10}{(12)}$	35	30	24	27	7	38	A2法兰
	5~30	32	257	130	170	210	165	13	27	76.5	18	208	140	113	55	50	32	36.5	10	30	25	19	21	5	19.5	A2法兰
	40~100	40	305	150	210	265	198	15	32.5	89	24	252	162	129.5	65	60	40	44	$\frac{10}{(12)}$	35	30	24	27	7	38	A2法兰
2.2KW	120~200	50	352	170	265	321	210	18	40	120	31	305	200	160	75	70	50	53.5	14	45	40	28	31	8	51.2	A2法兰
	5~30	32	257	130	170	210	165	13	27	76.5	18	208	140	113	55	50	32	36.5	10	30	25	19	21	5	19.5	A2法兰
	40~100	40	305	150	210	265	198	15	32.5	89	24	252	162	129.5	65	60	40	44	$\frac{10}{(12)}$	35	30	24	27	7	38	A2法兰
3.7KW	15~60	40	305	150	210	265	198	15	32.5	89	24	252	162	129.5	65	60	40	44	$\frac{10}{(12)}$	35	30	28	27	7	39	A2法兰
	75~120	50	352	170	265	321	210	18	40	120	31	305	200	160	75	70	50	53.5	14	45	40	28	31	8	53	A2法兰
3.7KW	5~20	40	305	150	210	265	198	15	32.5	89	24	252	162	129.5	65	60	40	44	$\frac{10}{(12)}$	35	30	28	27	7	39	A2法兰
	25~100	50	352	170	265	321	210	18	40	120	31	305	200	160	75	70	50	53.5	14	45	40	28	31	8	53	A2法兰

1. *为轻扭力之机型/*Indicates motor of smaller torque.
 2. 40~50筒齿箱上附加O型吊环 (高度约50mm)/ "O" type rings shall be attached to the 40~50mm gear box.(add.Height:50mm)
 < 以上数值若有变动, 恕不另行通知>/We reserve the right to change without further notice.

► G系列 (立式) 双轴型齿轮减速机

G Series Vertical Type Gear Reducer

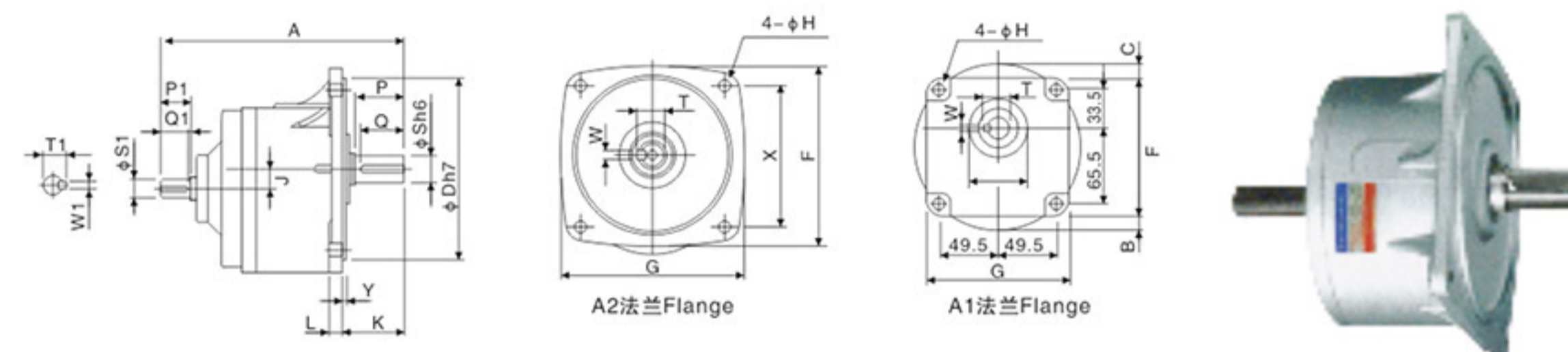

GH(L)F-Z

► 马达尺寸表

Dimensions

马力 (KW)	减速比 Gear Ratio	框号 Type	A	D	E	X	F	G	H	J	K	L	Y	出力轴端Output Shaft					入力轴端Input Shaft					重量 App.Wt.Kg	备注
														P	Q	S	T	W	P1	Q1	S1	T1	W1		
0.1KW	3-50	18	167	50	140	99	120	120	9	16.5	40	12	6	30	27	18	20	5	25	22	14	15.5	4	3	A1法兰
	60~200	22	194	148	185	131	175	165	11	18	48	12	3	40	35	22	25	7	25	22	14	15.5	4	4.2	A2法兰
0.2KW	5~10	18	167	50	140	99	120	120	9	16.5	40	12	6	30	27	18	20	5	25	22	14	15.5	4	3	A1法兰
	12.5~25	18*	167	50	140	99	120	120	9	16.5	40	12	6	30	27	18	20	5	25	22	14	15.5	4	3	A1法兰
	12.5~100	22	174	148	185	131	175	165	11	18	48	12	3	40	35	22	25	7	25	22	14	15.5	4	4.2	A2法兰
0.4KW	120~200	28	221	170	220	156	205	195	12	22	51	16	3	45	40	28	31	7	30	25	16	18	5	5.5	A2法兰
	5~10	22	194	148	185	131	175	165	11	18	48	12	3	40	35	22	25	7	25	22	14	15.5	4	4.2	A2法兰
	12.5~25	22*	194	148	185	131	175	165	11	18	48	12	3	40	35	22	25	7	25	22	14	15.5	4	4.2	A2法兰
	12.5~100	28	221	170	220	156	205	195	12	22	51	16	3	45	40	28	31	7	30	25	16	18	5	5.5	A2法兰
0.75KW	120~200	32	257	185	255	180	248	225	15	27	65	16	3	55	50	32	36.5	10	30	25	19	21	5	16	A2法兰
	5~10	28	221	170	220	156	205	195	12	22	51	16	3	45	40	28	31	7	30	25	16	18	5	6.5	A2法兰
	30~120	32	257	185	255	180	248	225	15	27	65	16	3	55	50	32	36.5	10	30	25	19	21	5	19.5	A2法兰
1.5KW	120~200	40	305	230	310	219	291	272	15	32.5	85	20	5	65	60	40	44	$\frac{10}{(12)}$	35	30	24	27	7	38	A2法兰
	5~30	32	257	185	255	180	248	225	15	27	65	16	3	55	50	32	36.5	10	30	25	19	21	5	19.5	A2法兰
	40~100	40	305	230	310	219	291	272	15	32.5	85	20	5	65	60	40	44	$\frac{10}{(12)}$	35	30	24	27	7	38	A2法兰
2.2KW	120~200	50	352	280	390	276	372	342	18	40	92	21	5	75	70	50	53.5	14	45	40	28	31	8	51.2	A2法兰
	15~60	40	305	230	310	219	291	272	15	32.5	85	20	5	65	60	40	44	14	35	30	24	27	7	39	A2法兰
3.7KW	75~120	50	352	280	390	276	372	342	18	40	92	21	5	75	70	50	53.5	$\frac{10}{(12)}$	45	40	28	31.1	8	53	A2法兰
	5~20	40	305	230	310	219	291	272	15	32.5	85	20	5	65	60	40	44	14	35	30	24	27	7	39	A2法兰
25~100	50	352	280	390	276	372	342	18	40	92	21	5	75	70	50	53.5	$\frac{10}{(12)}$	45	40	28	31.1	8	53	A2法兰	

1. *为轻扭力之机型。
 1. *Indicates motor of smaller torque.
 < 以上数值若有变动, 恕不另行通知>/We reserve the right to change without further notice.

G系列 (卧式) 自配马达减速机

G Series Self-Contained Motor Type Gear Reducer

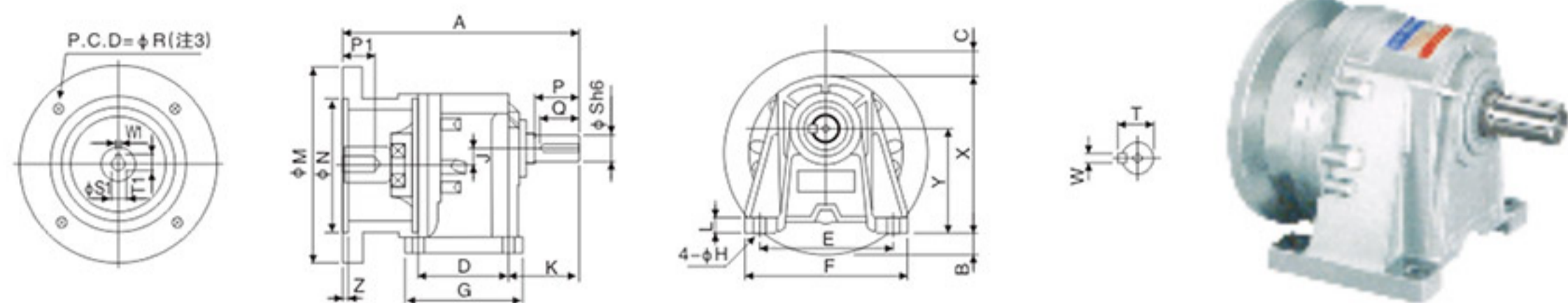

GH(L)W-K

马达尺寸表

Dimensions

马力 (KW)	减速比 Gear Ratio	框号 Type	输入轴端Input Shaft																	输出轴端Output Shaft					重量 App.Wt.Kg	备注					
			A	B	C	D	E	F	G	H	J	K	L	M	N	R	X	Y	Z	P1	S1	T1	W1	P			Q	S	T	W	
0.1KW	3-50	18	155	11	22	40	110	135	65	9	16.5	50	10	140	95	115	133	88.5	4	26	11	12.7	4	30	27	18	20.2	5	5		
	60~200	22	175	8	8	65	130	158	90	11	18	60	13	140	95	115	147	97.5	4	26	11	12.7	4	40	35	22	25	7	6.2		A2法兰
0.2KW	3~10	18	155	11	22	40	110	135	65	9	16.5	50	10	140	95	115	133	88.5	4	26	11	12.7	4	30	17	18	20.2	5	5		A1法兰
	12.5~25	18*	155	11	22	40	110	135	65	9	16.5	50	10	140	95	115	133	88.5	4	26	11	12.7	4	30	17	18	20.2	5	5		A1法兰
	12.5~100	22	175	8	8	65	130	158	90	11	18	60	13	140	95	115	147	97.5	4	26	11	12.7	4	40	35	22	25	7	6.2		A2法兰
0.4KW	120~200	28	191	-	-	90	140	178	120	11	22	62	16	140	95	115	171	116	4	26	11	12.7	4	45	40	28	31	7	7.5		A2法兰
	3~10	22	185	8	8	65	130	158	90	11	18	60	13	140	95	115	147	97.5	4	33	14	16.2	5	40	35	22	25	7	6.2		A2法兰
	12.5~25	22*	185	8	8	65	130	158	90	11	18	60	13	160	110	130	147	97.5	4	33	14	16.2	5	40	35	22	25	7	6.2		A2法兰
	12.5~100	28	201	-	-	90	140	178	120	11	22	62	16	160	110	130	171	116	4	33	14	16.2	5	45	40	28	31	7	7.5		A2法兰
0.75KW	120~200	32	226	-	-	130	170	210	165	13	27	76.5	18	160	110	130	208	140	4	33	14	16.2	5	55	50	32	36.5	10	19		A2法兰
	3~10	22	175	7	-	148	185	131	175	165	11	18	48	12	160	110	130	3	4	33	14	16.2	5	40	35	22	25	7	6.2		A2法兰
	12.5~25	22*	175	7	-	148	185	131	175	165	11	18	48	12	160	110	130	3	4	33	14	16.2	5	40	35	22	25	7	6.2		A2法兰
1.5KW	120~200	32	246	-	-	130	170	210	165	13	27	76.5	18	200	130	165	208	140	4.5	53	24	27.2	8	55	50	32	36.5	10	20.5		A2法兰
	3~10	22	175	7	-	148	185	131	175	165	11	18	48	12	160	110	130	3	4	33	14	16.2	5	40	35	22	25	7	6.2		A2法兰
	12.5~25	22*	175	7	-	148	185	131	175	165	11	18	48	12	160	110	130	3	4	33	14	16.2	5	40	35	22	25	7	6.2		A2法兰
2.2KW	120~200	32	226	-	-	185	255	180	248	225	15	27	65	16	160	110	130	3	4	33	14	16.2	5	55	50	32	36.5	10	19		A2法兰
	3~10	22	175	7	-	148	185	131	175	165	11	18	48	12	160	110	130	3	4	33	14	16.2	5	40	35	22	25	7	6.2		A2法兰
	12.5~25	22*	175	7	-	148	185	131	175	165	11	18	48	12	160	110	130	3	4	33	14	16.2	5	40	35	22	25	7	6.2		A2法兰
3.7KW	120~200	40	259	-	-	230	310	219	291	272	15	32.5	85	20	200	130	165	5	4.5	43	19	21.7	6	65	60	40	44	10(12)	39		A2法兰
	3~10	22	175	7	-	148	185	131	175	165	11	18	48	12	160	110	130	3	4	33	14	16.2	5	40	35	22	25	7	6.2		A2法兰
	12.5~25	22*	175	7	-	148	185	131	175	165	11	18	48	12	160	110	130	3	4	33	14	16.2	5	40	35	22	25	7	6.2		A2法兰

- *为轻扭力之机型/*Indicates motor of smaller torque.
 - 40~50筒齿箱上附加O型吊环 (高度约50mm) / "O" type rings shall be attached to the 40~50mm gear box. (add.Height:50mm)
 - 中间轴螺孔0.1~0.4为M8 0.75~1.5为M10 2.2~3.7为M12/Central screw hole for 0.1~0.4 motor shall be M8 Central screw hole for 0.75~1.5 motor shall be M10 Central screw hole for 2.2~3.7 motor shall be M12
- <以上数值若有变动, 恕不另行通知>/We reserve the right to change without further notice.

G系列 (立式) 自配马达减速机

G Series Self-Contained Motor Type Gear Reducer

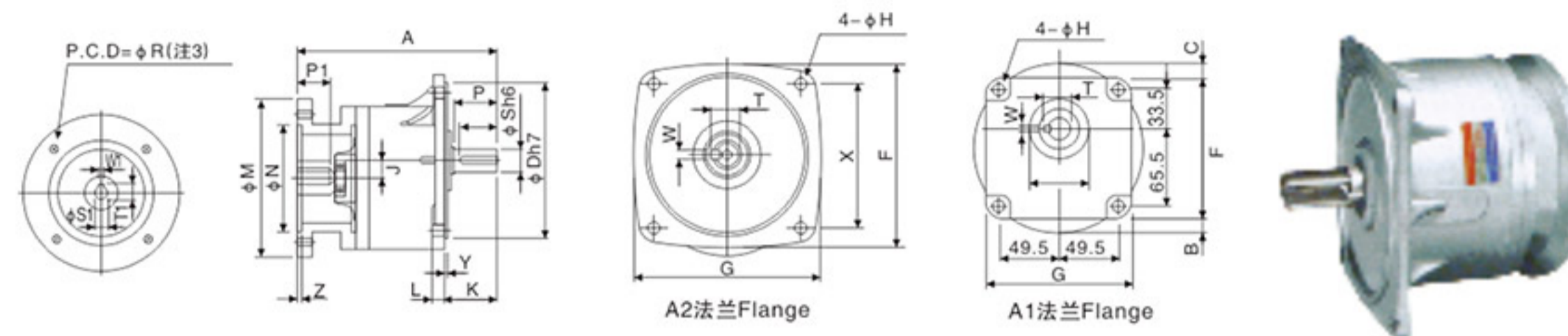

GH(L)F-K

马达尺寸表

Dimensions

马力 (KW)	减速比 Gear Ratio	框号 Type	输入轴端Input Shaft																	输出轴端Output Shaft					重量 App.Wt.Kg	备注				
			A	B	C	D	E	X	F	G	H	J	K	L	M	N	R	Y	Z	P1	S1	T1	W1	P			Q	S	T	W
0.1KW	3-50	18	165	20	20	50	140	99	120	120	9	16.5	40	12	140	95	115	6	4	26	11	12.7	4	30	27	27	20.2	5	5	A1法兰
	60~200	22	175	7	-	148	185	131	175	165	11	18	48	12	140	95	115	3	4	26	11	12.7	4	40	35	22	25	7	6.2	A2法兰
0.2KW	3~10	18	155	20	20	50	140	99	120	120	9	16.5	40	12	140	95	115	6	4	26	11	12.7	4	30	27	18	20.2	5	5	A1法兰
	12.5~25	18*	155	20	20	50	140	99	120	120	9	16.5	40	12	140	95	115	6	4	26	11	12.7	4	30	27	18	20.2	5	5	A1法兰
	12.5~100	22	175	7	-	148	185	131	175	165	11	18	48	12	140	95	115	3	4	26	11	12.7	4	40	35	22	25	7	6.2	A2法兰
0.4KW	120~200	28	191	-	-	170	220	156	205	195	12	22	51	16	140	95	115	3	4	26	11	12.7	4	45	40	28	31	7	7.5	A2法兰
	3~10	22	175	7	-	148	185	131	175	165	11	18	48	12	160	110	130	3	4	33	14	16.2	5	40	35	22	25	7	6.2	A2法兰
	12.5~25	22*	175	7	-	148	185	131	175	165	11	18	48	12	160	110	130	3	4	33	14	16.2	5	40	35	22	25	7	6.2	A2法兰
	12.5~100	28	202	-	-	170	220	156	205	195	12	22	51	16	160	110	130	3	4	33	14	16.2	5	45	40	28	31	7	7.5	A2法兰
0.75KW	120~200	32	226	-	-	185	255	180	248	225	15	27	65	16	160	110	130	3	4	33	14	16.2	5	55	50	32	36.5	10	19	A2法兰
	3~10	22	175	7	-	148	185	131	175	165	11	18	48	12	160	110	130	3	4	33	14	16.2	5	40	35	22	25	7	6.2	A2法兰
	12.5~25	22*	175	7	-	148	185	131	175	165	11	18	48	12	160	110	130	3	4	33	14	16.2	5	40	35	22	25	7	6.2	A2法兰
1.5KW	120~200	32	246	2	-	185	255	180	248	225	15	27	65	16	200	130	165	3	4.5	43	19	21.7	6	55	50	32	36.5	10	20.5	A2法兰
	3~10	22	175	7	-	148	185	131	175	165	11	18	48	12	160	110	130	3	4	33	14	16.2	5	40	35	22	25	7	6.2	A2法兰
	12.5~25	22*	175	7	-	148	185	131	175	165	11	18	48	12	160	110	130	3	4	33	14	16.2	5	40	35	22	25	7	6.2	A2法兰
2.2KW	120~200	40	275	-	-	230	310	219	291	272	15	32.5	85	20	200	130	165	5	4.5	43	19	21.7	6	65	60	40	44	10(12)	39	A2法兰
	3~10	22	175	7	-	148	185	131	175	165	11	18	48	12	160	110	130	3	4	33	14	16.2	5	40	35	22	25	7	6.2	A2法兰
3.7KW	120~200	40	275	-	-	280	390	276	372	342	18	40	92	21	200	130	165	5	4.5	53	24	27.2	8	80	75	50	53.5	14	52.2	A2法兰
	3~10	22	175	7	-	148	185	131	175	165	11	18	48	12	160	110	130	3	4	33	14	16.2	5	40	35	22	25	7	6.2	A2法兰

- *为轻扭力之机型/*Indicates motor of smaller torque.
 - 40~50筒齿箱上附加O型吊环 (高度约50mm) / "O" type rings shall be attached to the 40~50mm gear box. (add.Height:50mm)
 - 中间轴螺孔0.1~0.4为M8 0.75~1.5为M10 2.2~3.7为M12/Central screw hole for 0.1~0.4 motor shall be M8 Central screw hole for 0.75~1.5 motor shall be M10 Central screw hole for 2.2~3.7 motor shall be M12
- <以上数值若有变动, 恕不另行通知>/We reserve the right to change without further notice.